

stay^{safe}[™] SANITISER ZONE

INSTRUCTION MANUAL

AUTOMATIC SPRAY HAND SANITISER ZONE

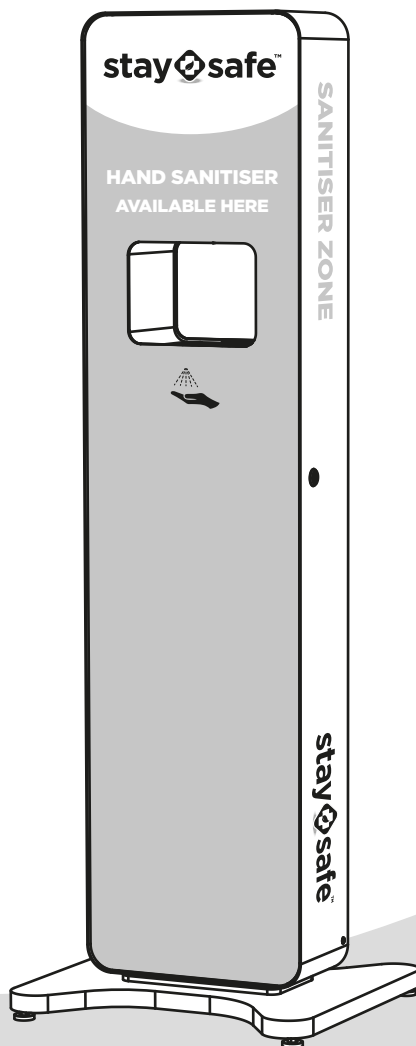
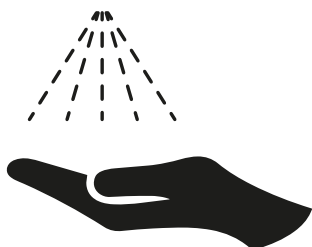

Please read user manual carefully before using

Also visit staysafesanitiser.com for helpful tips & videos

Thank you for purchasing a Stay Safe™ Sanitiser Zone.
Our goal is to provide you, your team and your customers a convenient way to Stay Safe™.

PACKAGE CONTENTS

PACKAGE A

1X

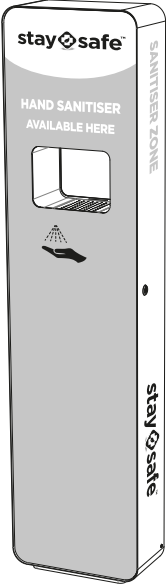

stay safe
HAND SANITISER
AVAILABLE HERE

SANITISER ZONE

stay safe

1X



stay safe
SANITISER ZONE
INSTRUCTION MANUAL

AUTOMATIC
SPRAY
HAND SANITISER
ZONE

Please read user manual carefully before using

Assembly Instruction
Sheet

1X



stay safe
SANITISER ZONE
INSTRUCTION MANUAL

AUTOMATIC
SPRAY
HAND SANITISER
ZONE

Please read user manual carefully before using

User Manual
Booklet

2X

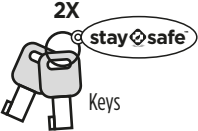

stay safe
Keys

4X

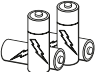

AA Batteries
(May be supplied separately)

1X



DC Adapter
(May be supplied separately)

1X

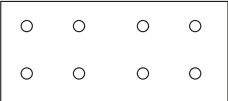

Concrete Anchor Drilling Template

PACKAGE B

1X

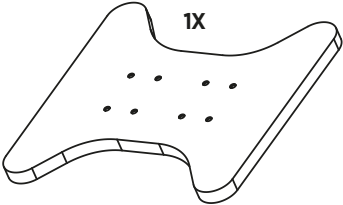

Freestanding Base Frame

4X



Adjustable Feet

4X



Castors

8X



Nuts, Washers, Bolts

2X

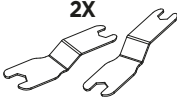

Spanner Tool

1X



stay safe
SANITISER ZONE
INSTRUCTION MANUAL

AUTOMATIC
SPRAY
HAND SANITISER
ZONE

Please read user manual carefully before using

Assembly Instruction
Sheet

PACKAGE C - OPTIONAL EXTRA

WALL MOUNT KIT - ORDER SEPARATELY

1X



Wall Mount Base Plate

8X



Nuts, Washers

4X



Wall Spacer Washers

1X



stay safe
SANITISER ZONE
INSTRUCTION MANUAL

AUTOMATIC
SPRAY
HAND SANITISER
ZONE

Please read user manual carefully before using

Assembly
Instruction
Sheet

COMPONENTS

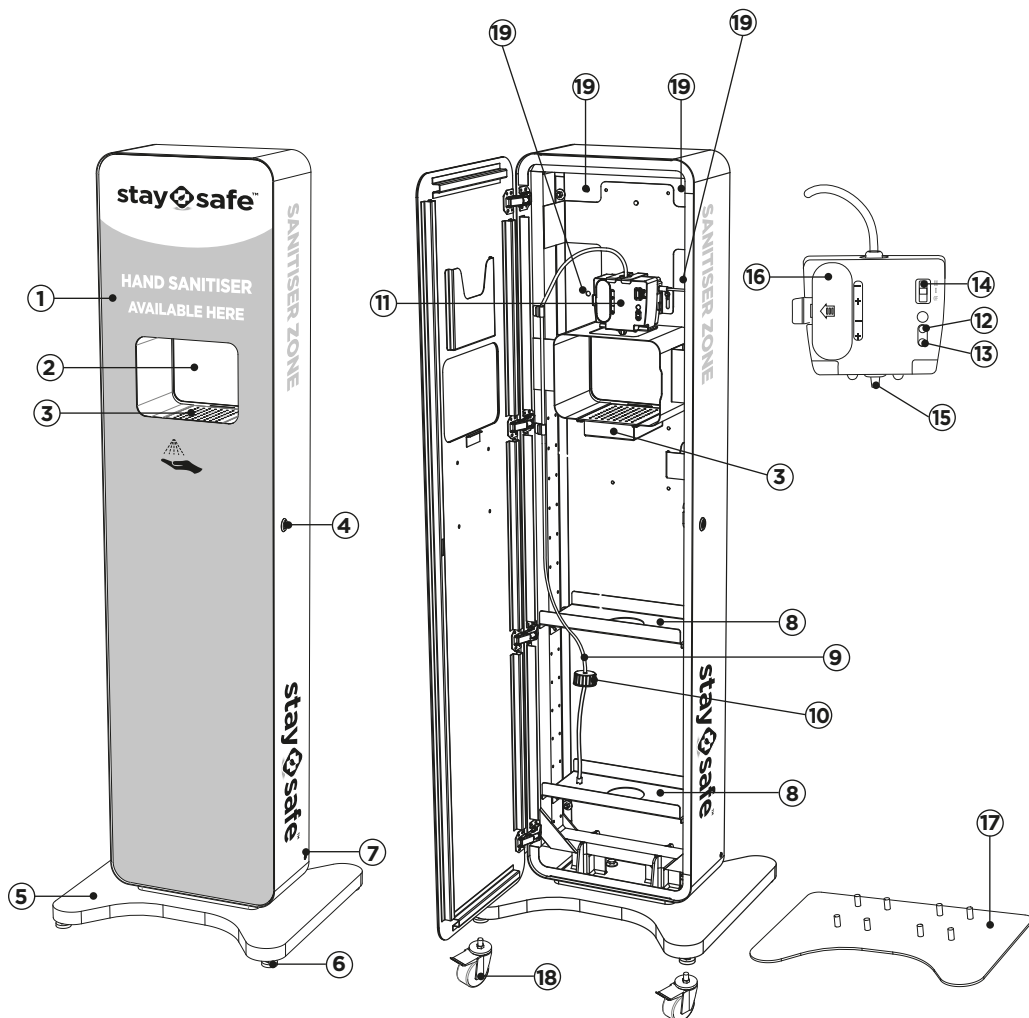

1. Graphic Panel
2. Sanitisation Area
3. Removable Drip Tray
4. Front Access Door Lock
5. Freestanding Baseplate
6. Adjustable Feet
7. DC Power Socket

8. Sanitiser Bottle Shelves
9. Sanitiser Liquid Pickup Pipe
10. Sanitiser Bottle Pickup Cap & Tube
11. Sanitiser Pump Mechanism (See Detail)
12. Red Indicator Light
13. Green Indicator Light

14. Power On/Off + Dosage Switch
15. Spray Outlet
16. Battery Housing
17. Optional Wall Standing Plate
18. Optional Lockable Castors
19. Concealed Holes For Securing To Wall

FREE STANDING BASE INSTALLATION

- Unit is heavy. Base assembly requires assistance. Minimum 2 people.
- Cover the floor with soft coverings to prevent the unit from scratches & damage.
- Find a clear, safe work area to unpack the unit. Unit is best unpacked by opening the top flaps, then carefully turning the box around so the box opening is facing down, and lifting the box off the unit, not lifting the unit out of the box.
- Lay the unpacked unit on its side and prop up the unit so that there is room for the door to open & base plate to be fitted.
- Locate the base plate & 8 x Locking bolts as shown.
- With the door open, align the base plate with the 8 x holes on the bottom of the unit and assemble together by inserting the bolts up through the base plate, and then finger tightening the supplied washers & nuts to the bolts on the inside of the unit.
- Once all bolts are in position, firmly tighten bolts using supplied tools.
- Fit supplied adjustable feet (or castors) by screwing them into the 4 holes on the bottom of base as shown.
- Unit is now ready to be stood up. Using assistance, carefully tilt unit onto base and into suitable position.
- Adjust feet to level unit or lock castors to secure in place.

1-4

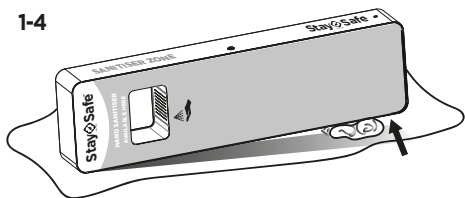

5

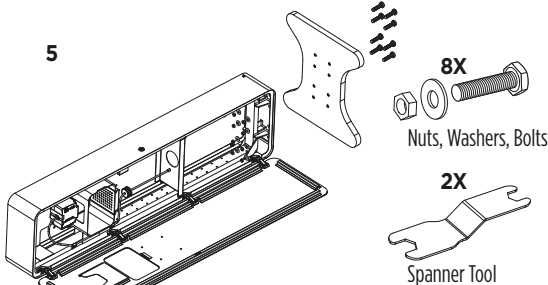

6-7

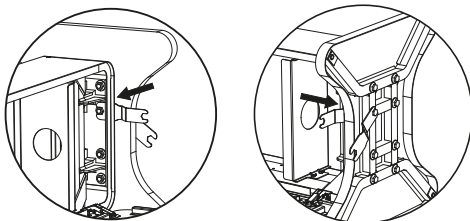
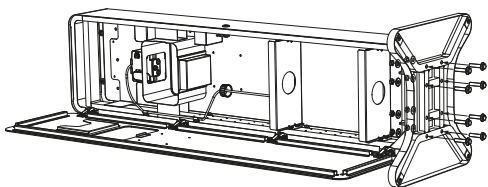

NOTE: Nuts on the inside of the unit can be tightened by sliding the supplied tool between the base & bottom of main unit as shown.

8

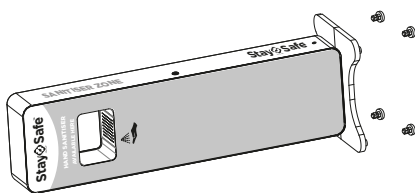

4X



Adjustable Feet

4X



Optional Castors

NOTE: To tighten Castors, first apply the Castor brake, then twist the Castor to screw in tightly. Release brakes to roll around freely. Always apply brakes when unit stationary.

9-10

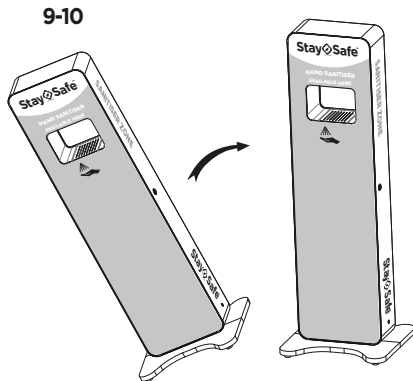

WALL STANDING INSTALLATION

NOTE: Wall fixing should be done by a suitably qualified licensed builder or installer. Unit is heavy and must **NOT** be mounted elevated on a wall. Unit must be resting on the ground using the Optional “Wall Mount Base Plate Kit”, then pushed up against the wall and secured through the back of the unit to the wall, utilising the indicated mounting holes. Suitably rated wall fixings to be used depending on the wall structure being mounted to. Attach fixings to suitably structural wall surfaces. Stay Safe™ takes no responsibility for incorrectly installed wall units.

1. Unit is heavy. Wall assembly requires assistance.
Minimum 2 people
2. Cover the floor with soft coverings to prevent the unit from scratches & damage. Find a clear safe work area to unpack the unit.
3. Lay the unit on its back with door opening facing up.
4. Locate the Wall Base plate & 8 x Locking nuts & washers as shown.
5. Open the door and support it open so as not to put excess pressure on the hinges.
6. Align the base plate with the 8 x holes on the bottom of the unit and assemble together by finger tightening the
- supplied nuts & washers. Once all nuts are in position, firmly tighten using supplied tool.
7. Unit is now ready to be stood up. Using assistance, carefully tilt up unit onto base and into suitable position against wall.
8. Whilst your assistant holds the unit upright, open the unit door and locate the wall mount holes on the inside of the unit and mark out their centres against the wall you are mounting to.
9. Fix the unit securely through the holes into the wall using suitable fixings for the wall that you are fixing to.
NOTE: Spacer washers have been provided to sandwich between unit & wall through your wall fixings.

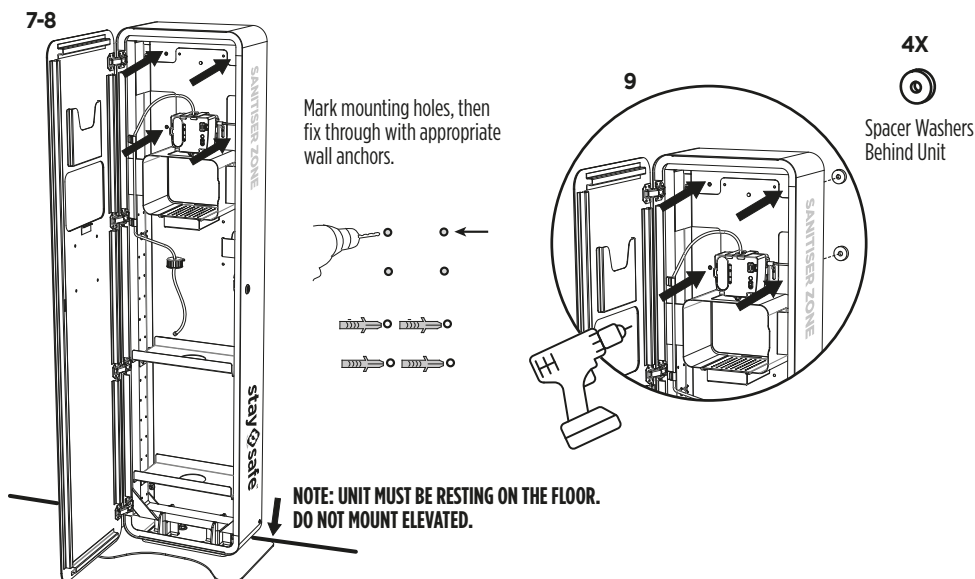
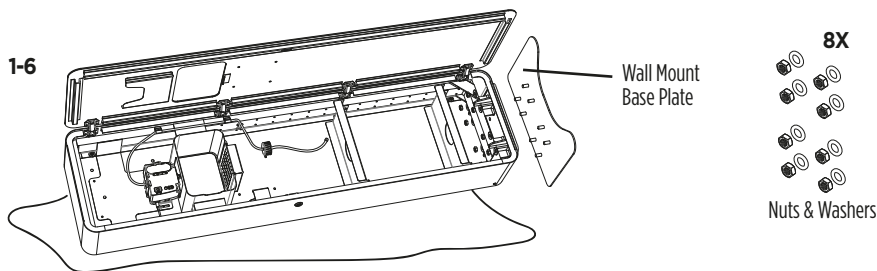

CONCRETE FLOOR FIXED MOUNTING

NOTE: Concrete floor fixing should be done by a suitably qualified licensed builder or installer.

Engineer Certified fixing method to concrete (Fixings Not Included):

- Use 8 x Hilti HIT-HY 200-R + HIT-Z-R M10 96mm embedment into concrete (or)
- Use 8 x Hilti HIT-HY 200-R + HIT-V-R M10 123mm embedment into concrete
- 160mm minimum concrete depth, 335mm minimum bolt centre distance to concrete edge.

Stay Safe™ takes no responsibility for incorrectly installed floor units.

1. Unit is heavy. Installation requires assistance. Minimum 2 people.
2. Cover the floor with soft coverings to prevent the unit from scratches & damage.
3. Find a clear safe work area to unpack the unit.
4. Open the unit and remove bottom shelf to make access to base plate bolts easier when installing. (Loosen wingnuts to remove shelf. Remember shelf location for re-installation)
5. Mark out & drill appropriate anchor points in concrete floor using the base plate template provided.
6. Fix appropriate engineer recommended concrete floor anchors into floor, ensuring installation is done as per manufacturer specifications.
7. When anchor bolts are ready, raise the unit over the anchor bolts, aligning the base plate with the 8 x anchor points and firmly tighten all nuts with washers using appropriate tool to torque nuts to manufacturer recommendation.
8. Re-install bottom shelf in same location. Unit is now ready for use.

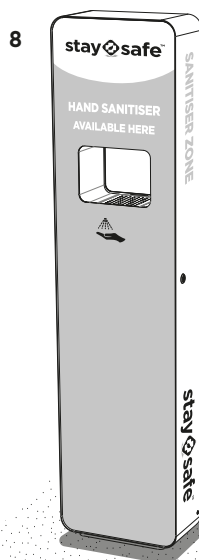
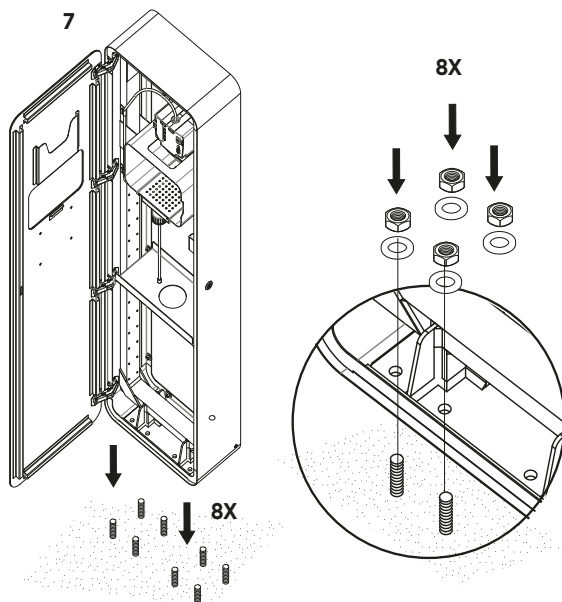
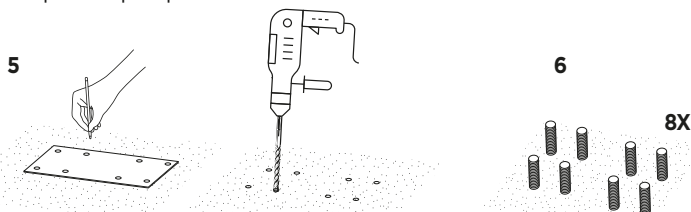

BATTERY LOADING

1. Unlock the unit, open the front door and locate the Pump mechanism as shown.

Ensure the DC power adapter is NOT plugged in if you are using batteries.

Turn the unit to the OFF position.

2. Remove battery cap by releasing the latch to the left then lifting the cap off.

3. Insert 4 x AA high capacity alkaline batteries correctly as indicated with the + -.

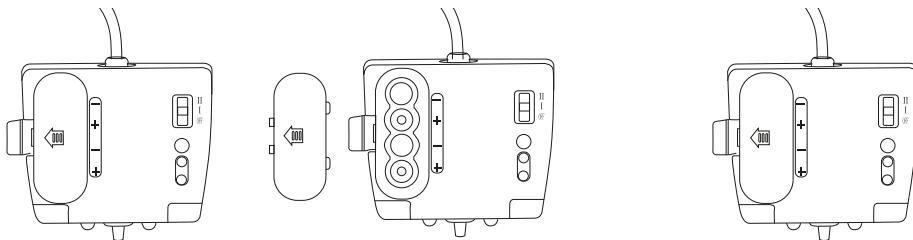

4. Re-attach the battery cover and secure the left latch to lock into position.

5. Turn the dispenser on by using the ON switch and select the desired dosage position:

I = 0.5ml / II = 1.0mL (NOTE: Liquid amount will vary depending on battery power remaining)

The Red LED light will blink fast when unit is switched on and function set.

The Red LED light will blink once every 3 seconds when battery power is low.

The Green LED light will blink when the spray unit is activated by motion.

High capacity Alkaline batteries will allow the unit to achieve approximately 15,000 doses between changes.

AC/DC POWER CONNECTION

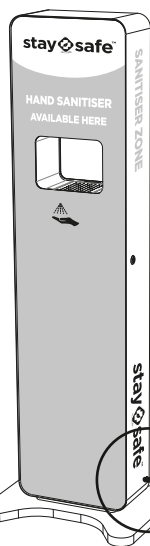

1. Unlock the unit, open the front door and locate the Pump mechanism as shown.

2. Turn the unit to the OFF position.

3. Ensure ALL batteries are removed from unit before you plug in DC power.

4. Insert supplied AC/DC Adapter plug into DC input socket on side at base of unit.

5. Plug DC outlet into wall socket & turn on power.

6. Turn the dispenser on by using the ON switch and select the desired dosage position: I = 0.5ml / II = 1.0mL

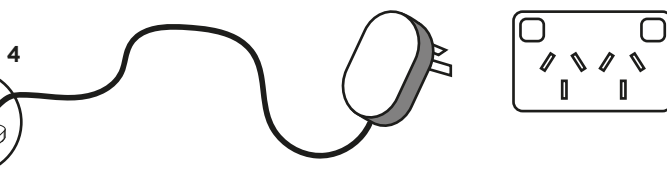

BOTTLE LOADING

NOTE:

- USE ONLY APPROVED Stay Safe™ SANITISER LIQUID.
- DO NOT USE GEL.
- USE OF ANY OTHER LIQUID MAY DAMAGE UNIT OPERATION & WILL VOID WARRANTY.
- Stay Safe™ SANITISER LIQUID IS 100% AUSTRALIAN MADE & IS SPECIFICALLY DESIGNED TO BE USED IN THE Stay Safe™ SANITISER ZONE TO ENSURE OPTIMUM PERFORMANCE & RELIABILITY.
- Stay Safe™ LIQUID CONFORMS TO THE WHO & TGA GUIDELINES FOR EFFICACIOUS HAND SANITISATION.



1. Unlock unit and open front door.
2. Turn off power to the pump mechanism.
3. Load your approved Stay Safe™ Sanitiser Liquid bottles onto the 2 shelves provided.
4. Unscrew the lid on one of the Stay Safe™ bottles.
5. Locate the bottle screw lid on the end of the sanitiser fluid tube. Insert tube into open bottle ensuring it reaches the bottom of the bottle. Tube can be carefully pulled through bottle lid to extend or shorten.
6. Screw lid shut.
7. Turn power switch on & to the number 2 (II) dosage setting for priming the tube.
8. Activate the pump multiple times by placing your hand under the sensor area. Repeat until all air is out of the tube and sanitiser begins to spray from the nozzle. Typically you will need to activate the pump 5-10 times before the tube is primed.
9. Once priming is complete adjust dosage setting to preferred location: I = 0.5ml / II = 1.0ml
10. Close the front door & lock the unit ensuring spray hose is clear from door & hinges when closing & does not get pinched.
11. Test spray mechanism to ensure it is functioning as desired.
12. Unit is ready for use.

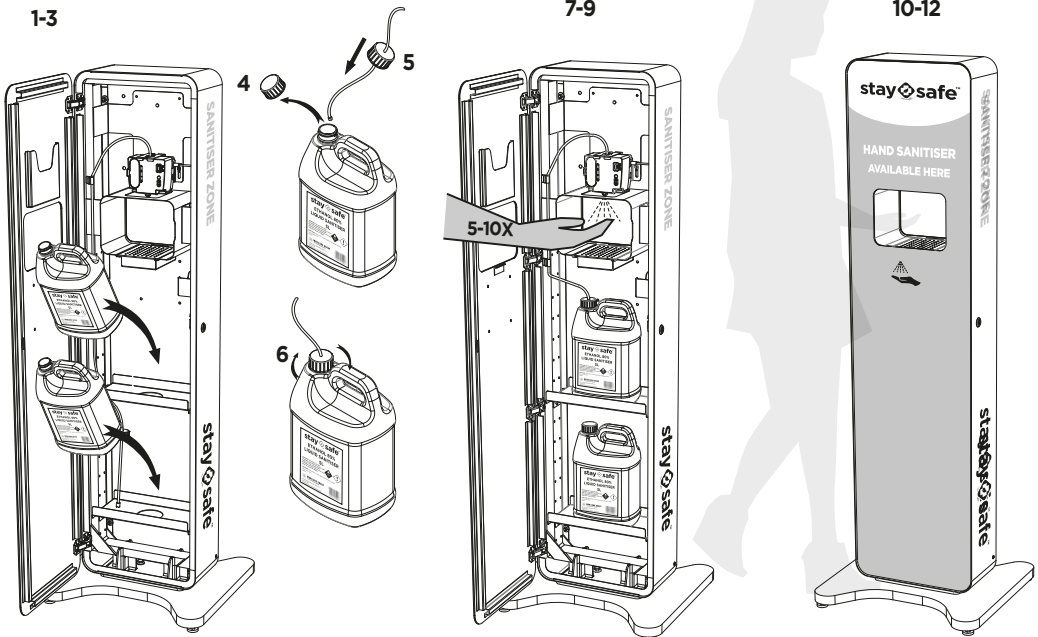

HOW TO OPERATE

- PLEASE AVOID THE SENSOR HEAD AREA BEING EXPOSED TO STRONG DIRECT SUNLIGHT.
- DO NOT OPERATE THE UNIT OUTDOORS, EXPOSED TO THE ELEMENTS, OR IN MOIST HIGH HUMIDITY ENVIRONMENTS.
- DO NOT OPERATE THE UNIT FOR EXTENDED PERIODS OF TIME WITH NO LIQUID PRESENT AND DO NOT USE GEL. DOING SO MAY DAMAGE THE UNIT & WILL VOID WARRANTY.
- REMOVE BATTERIES IF OPERATING THE UNIT VIA AC/DC POWER.

1. Place hand into Sanitisation area ensuring hand is within the operating area.
Operating area is 2-12cm below the spray outlet.
2. Unit will automatically spray the selected amount of sanitiser into palm.
3. Rub hands together front & back for 30 seconds, covering all surfaces, between fingers etc.

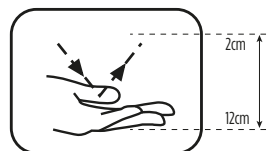

NOTE: You can FINE TUNE & customise the location of the sensor operation area by loosening the wing nuts on the pump housing and adjusting the height location of the pump. Tighten wing nuts once your ideal location is established.

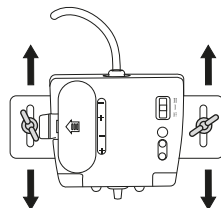

INTERCHANGEABLE GRAPHIC PANELS

Your Stay Safe™ Sanitiser Zone is equipped with easily removed & interchangeable front & back graphic panels. Panels attach to the Stay Safe™ unit by means of magnetic backing. To change your graphics, grab the edge of the graphic panel, and pull away from the unit. To re-attach, simply line up the panel with the unit, and place against the front/back panel so the magnets attach. Ensure graphics are aligned and centred.

CONTACT STAY SAFE™ FOR ADDITIONAL CUSTOMISED GRAPHIC PANELS

NOTE: If requested, your unit may have permanently affixed Front & Back graphic panels which can not be removed. Side graphics are permanent.

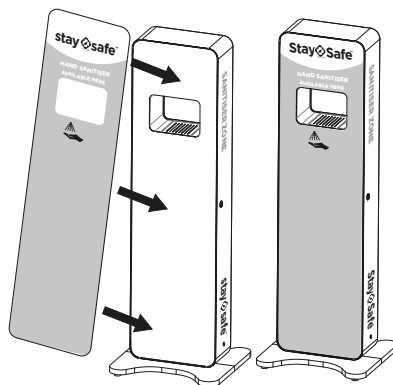

ENGINEERING LIMITATIONS

Below Engineering Limitations to be used as a guide only and are based on computer modelling. Real world results may vary. Stay Safe™ takes no responsibility for below performance or variances thereof.

Stay Safe™ Sanitiser Zone with Freestanding Adjustable Base Legs

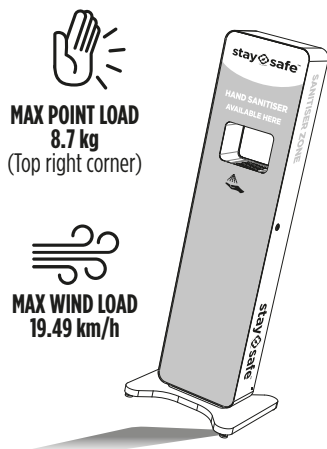

MAX POINT LOAD
8.7 kg
(Top right corner)

MAX WIND LOAD
19.49 km/h

Stay Safe™ Sanitiser Zone with Concrete Fixings

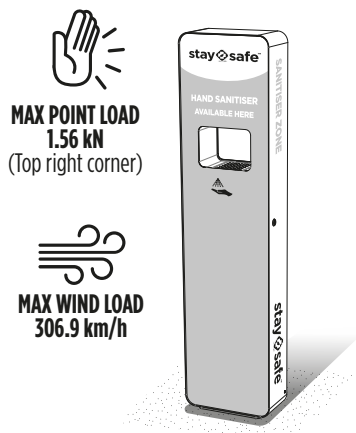

MAX POINT LOAD
1.56 kN
(Top right corner)

MAX WIND LOAD
306.9 km/h

(Note: Wind Loads based on Metal Structure. Removable graphic panels not included in above ratings and may dislodge in strong winds)

Structural Rating of Stay Safe™ Sanitiser Zone with Freestanding Adjustable Base Legs:

- 5.80kN point load rating
- 15.92km/hr wind load rating
- Overturning failure occurs with 8.70kg point load located at the top corner of the perimeter framing; 3.31mm elastic deformation
- Overturning failure occurs with 19.49km/hr wind loading perpendicular to unit face; 3.05mm elastic deformation

Structural Rating of Stay Safe™ Sanitiser Zone with Concrete Fixings:

- 0.60kN point load rating
- 55.10km/hr wind load rating
- 12.44mm elastic deformation with 0.60kN point load (equivalent to balustrade top edges in areas susceptible to over-crowding) located at the top corner of the perimeter framing
- 11.70mm elastic deformation (height/125 typical deformation limit for flexible cladding) with 55.10km/hr wind loading perpendicular to unit face
- 1.56kN point load rating before plastic deformation begins to occur
- 306.90km/hr wind loading perpendicular to unit face before plastic deformation begins to occur

Engineering analysis of the Stay Safe™ Sanitiser Zone conducted on the below Complied Australian Standards:

- AS1170.0 General Principles of Structural Design Actions
- AS1170.1 Permanent, Imposed and Other Actions
- AS1170.2 Wind Actions
- AS3600 Concrete Structures
- AS5216 Design of Post-Installed and Cast-In Fastenings in Concrete
- AS4100 Steel Structures

Full copy of Engineers Certificate available on request.

MAINTENANCE

CLEANING







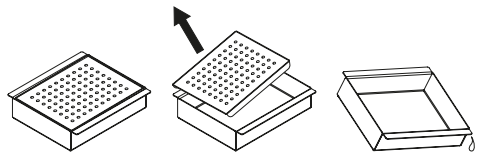







Do not use steel wool or cleaning agents that contain acidic or corrosive substances. Using any prohibited detergent will damage the surface of the unit. Wipe the surface only with water, then wipe it dry with a clean rag or towel.

DRIP TRAY

To empty drip tray, unlock unit & open front door. Remove drip tray. Separate drip tray cover from drip tray. Empty liquid drip tray responsibly and wipe dry. Re-assemble & replace back into unit.



CAUTION/WARNINGS

-  Please do not place unit in moist humid environments, direct sunlight, rain or exposed to the elements.
-  Do not misuse the unit, treat roughly, or tamper/damage any components.
-  Please remove battery and sanitiser liquid if unit to be left in storage or not used for extended periods.
-  Clean unit with moist cloth or rag.
-  Do not hose down the unit.
-  Do not drop, crash or intentionally break the unit.
-  Do not use corrosive chemical solvent cleaning products on or in the unit.
-  Do not let dust, dirt or foreign debris into the liquid dispenser.
-  Do not attempt to disassemble or repair unit yourself. Call for service.
-  Keep away from children.
-  Keep away from fire or naked flame.
-  Do not drink the Sanitiser liquid or place liquid on or near face, eyes, nose or mouth.
-  Do not use the unit for prolonged periods when the liquid is empty. Refill immediately or turn unit off.
-  Only use approved Stay Safe™ Sanitiser Liquid. Do not use other liquids. Do not use Gel.
-  Remove batteries from unit if using AC/DC Power.

NOTE: PLEASE REFER TO ENGINEERING LIMITATIONS FOR INSTALLATION & USAGE CONSTRAINTS!

SPECIFICATIONS

Product Name:	Stay Safe™ Sanitiser Zone
Suitable Liquid:	Only use Stay Safe™ Sanitiser Liquid
Dispense Mechanism:	Spray
Size (With Adjustable Feet):	(H)1505 x (D)460 x (W)500mm
Size (With Castors):	(H)1560 x (D)460 x (W)500mm
Size (Fixed to Concrete):	(H)1465 x (D)170 x (W)360mm
Weight (Unit without Base):	36 kg
Weight (Freestanding Base):	7 kg
Weight (Wall Mount Base):	3 kg
Spray Dosage:	(I) : 0.5ml (II): 1.0ml
Induction Method:	Infrared Reflection
Valid Induction Distance:	2-12cm
Material:	Powdercoated Mild Steel
Volume:	2 x 5L
Battery:	4 x AA Alkaline Battery
DC Adaptor:	Input voltage: AC100-240V Output voltage: DC 6V 2.2A

ENQUIRIES, SERVICE, REFILLS

stay safe™

staysafe@manildra.com.au

1800 227 862

staysafesanitiser.com



MANILDRA GROUP

100% AUSTRALIAN OWNED



**ONLY USE APPROVED
Stay Safe™
SANITISER LIQUID**

**USE OF NON APPROVED SANITISER LIQUID
MAY DAMAGE UNIT & WILL VOID WARRANTY.
DO NOT USE GEL.**